

Cibola National Forest (east half)

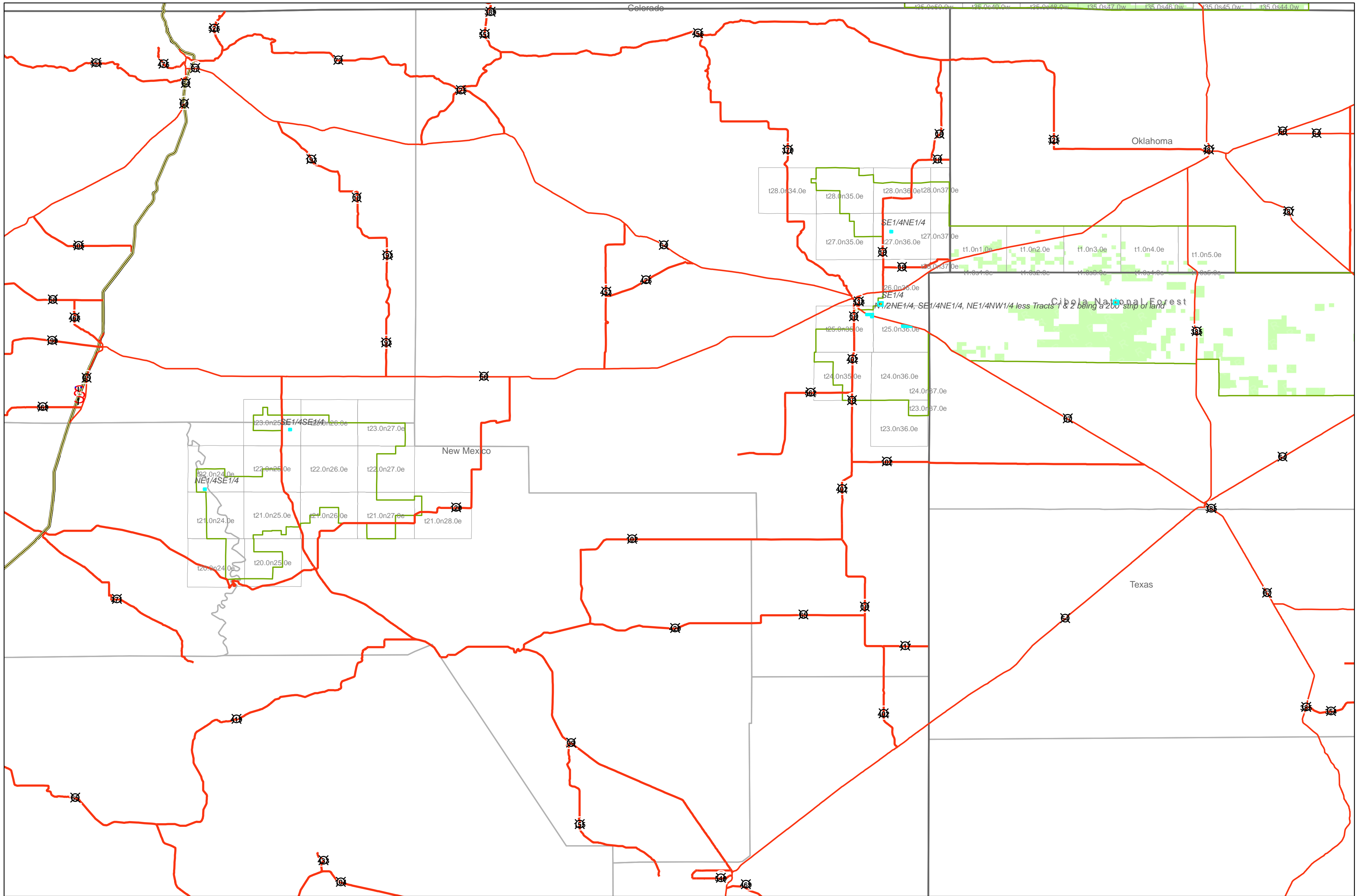

■ USFS parcels potentially eligible for sale
 State boundary
 County boundary
 Administrative Forest boundary
 PLSS Townships
 USFS ownership

Map created February 7th, 2007

1:528,245

Disclaimer: All parcels shown are subject to change without prior notification. The Forest Service does not warrant the current condition of title for parcels shown. Outstanding rights and restrictions may encumber the title to any or all of the subject parcels.

